



# SKYCITY2

## LIMITED-TIME SAVINGS ON FINAL FABULOUS SUITES

**S**kyCity2 Condominiums is under construction and first occupancies are slated for January 2018. Act now to own one of the final suites available at Pemberton Group's highly successful Richmond Hill community. The residence is situated in the amenity-rich, transportation-friendly City Centre at Yonge Street and Highway 7, within walking distance to the York Region Transit Hub. Residents can easily access GO Train and GO bus service, and will be able to walk to shopping, dining and entertainment venues.

SkyCity2's 20-storey tower features a contemporary lobby with 24-hour concierge service. The three-storey central podium will house over 17,000 sq. ft. of indoor and outdoor

amenities. Highlights include lushly landscaped grounds and courtyards with pathways; a theatre room; two video gaming rooms; a chic party room; dining room; a yoga/Pilates studio; equipped exercise room; indoor swimming pool and lounge with double-sided fireplace, and change rooms featuring steam showers. Residents will also appreciate SkyGarden, the landscaped terrace with an outdoor fireplace, gazebos and arbours, lounge-style seating, barbecue stations, and an al fresco dining area.

Suites have, all as per plan, 5 ½" wide laminate flooring, a pass-through in the kitchen, under-mount stainless steel double sink, contemporary designed cabinetry with 40"-high uppers, under-cabinet lighting

with a valance, choice of Caesarstone or granite countertops, glass or marble mosaic backsplash, high-quality appliances, and spa-inspired bathrooms with porcelain flooring.

Pemberton suite owners enjoy an enviable lifestyle in sought-after neighbourhoods across the Greater Toronto Area, plus the peace-of-mind that comes from buying from a well-trusted builder.

To learn more about this master-planned community, visit the sales centre soon. Available suites range in size from a well-proportioned 640 sq. ft. one-bedroom layout to the spacious 1,080 sq. ft. two-bedroom + den design. Prices start from the mid-\$300's, and include one underground parking space and a

locker. Until Feb 28, you can take advantage of Pemberton's Chinese New Year's Celebration and save 1% off already value-packed prices.

The SkyCity Presentation Centre and furnished kitchen/living room and bathroom vignettes are located at the corner of Red Maple Road and Highway 7. Hours are: Monday to Thursday from 12 to 7 p.m.; Weekends from 12 to 6 p.m.; Fridays Closed.

*For more information call 905.709.5700 or visit [pembertongroup.com](http://pembertongroup.com).*

**To learn more about Pemberton's many fine condominium communities and those coming soon, visit [pembertongroup.com](http://pembertongroup.com). You can also follow the company on Facebook, Twitter, Instagram and YouTube.**



The 17,000 square-feet of amenities include the sophisticated party room.

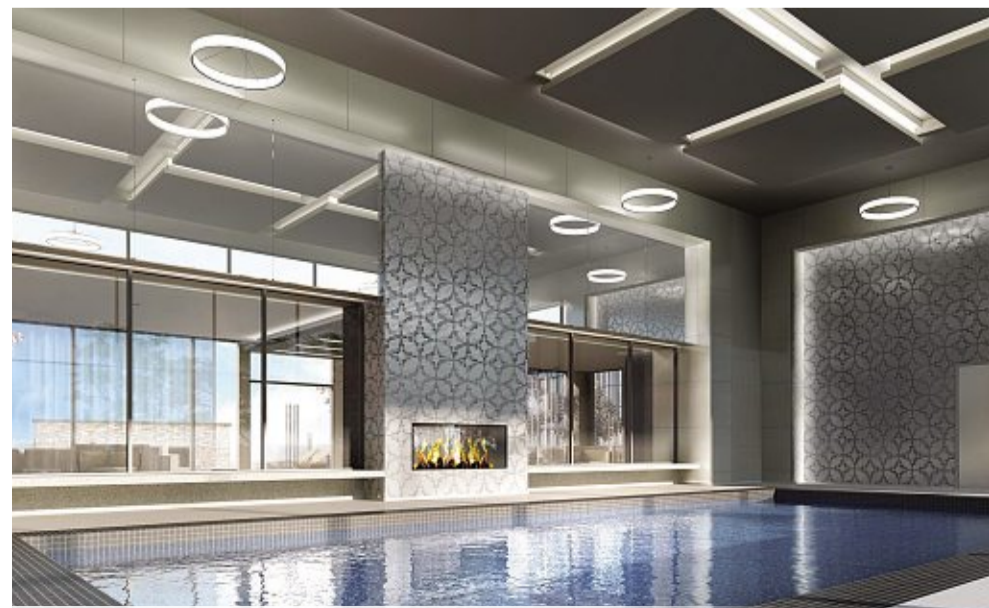

The indoor swimming pool and lounge share a double-sided fireplace.